

| ITEM NO. | Wire diameter (d) | DIMENSION | | MINI BREAK LOAD (kgf) |
|-----------|-------------------|-----------|------|-----------------------|
| | | D | H | |
| M-01-568 | Ø0.6 | Ø2.5 | 2 | 20 |
| M-01-640 | Ø0.6 | Ø3.3 | 4.5 | 20 |
| M-01-166 | Ø0.8 | Ø3.0 | 5 | 30 |
| M-01-880 | Ø0.8 | Ø3.0 | 5 | 30 |
| M-01-1015 | Ø0.8 | Ø3.0 | 5 | 30 |
| M-01-1016 | Ø0.8 | Ø3.0 | 5 | 30 |
| M-01-646 | Ø0.8 | Ø3.0 | 8 | 31 |
| M-01-252 | Ø1.0 | Ø3.2*4.7 | 11.5 | 30 |
| M-01-208 | Ø0.8 | Ø3.5 | 4.5 | 30 |
| M-01-647 | Ø0.8 | Ø3.7 | 14 | 30 |
| M-01-979 | Ø0.8 | Ø3.8 | 11.5 | 31 |
| M-01-697 | Ø0.8 | Ø4.0 | 4 | 30 |
| M-01-933 | Ø0.8 | Ø4.0 | 4 | 30 |
| M-01-181 | Ø0.8 | Ø4.0 | 6 | 30 |
| M-01-538 | Ø0.8 | Ø4.0 | 8 | 30 |
| M-01-312 | Ø0.8 | Ø4.0 | 15 | 30 |
| M-01-164 | Ø0.8 | Ø4.5 | 4.5 | 30 |
| M-01-232 | Ø0.8 | Ø4.5 | 5 | 30 |
| M-01-859 | Ø0.8 | Ø4.7 | 4.5 | 30 |
| M-01-999 | Ø0.8 | Ø4.7 | 5.2 | 30 |
| M-01-727 | Ø0.8 | Ø4.8 | 4.7 | 30 |
| M-01-376 | Ø0.8 | Ø5.0 | 4.5 | 30 |
| M-01-031 | Ø0.8 | Ø5.5 | 3 | 30 |
| M-01-087 | Ø0.8 | Ø5.5 | 3 | 30 |

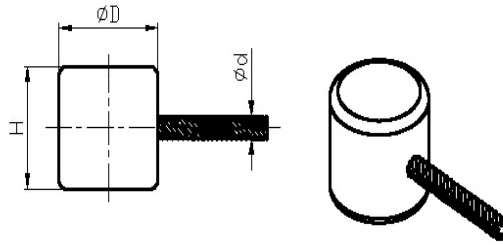

| ITEM NO. | Wire diameter (d) | DIMENSION | | MINI BREAK LOAD (kgf) |
|----------|-------------------|-----------|------|-----------------------|
| | | D | H | |
| M-01-189 | Ø0.8 | Ø5.5 | 3 | 30 |
| M-01-187 | Ø0.8 | Ø5.5 | 3 | 30 |
| M-01-310 | Ø0.8 | Ø6.0 | 8 | 30 |
| M-01-574 | Ø0.8 | Ø6.0 | 8 | 30 |
| M-01-534 | Ø0.8 | Ø7.0 | 6 | 30 |
| M-01-185 | Ø1.0 | Ø3.0 | 5 | 50 |
| M-01-783 | Ø1.0 | Ø3.5 | 4 | 50 |
| M-01-209 | Ø1.0 | Ø3.5 | 4.5 | 50 |
| M-01-790 | Ø1.0 | Ø3.5 | 12.3 | 50 |
| M-01-877 | Ø1.0 | Ø3.5 | 3.9 | 50 |
| M-01-643 | Ø1.0 | Ø3.9 | 5.9 | 50 |
| M-01-156 | Ø1.0 | Ø4.0 | 4 | 50 |
| M-01-856 | Ø1.0 | Ø4.0 | 4 | 50 |
| M-01-995 | Ø1.0 | Ø4.0 | 4 | 50 |
| M-01-198 | Ø1.0 | Ø4.0 | 5 | 50 |

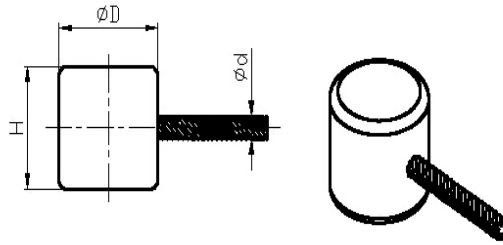

| ITEM NO. | Wire diameter (d) | DIMENSION | | MINI BREAK LOAD (kgf) |
|----------|-------------------|-----------|---------|-----------------------|
| | | D | H | |
| M-01-895 | Ø0.8 coating Ø1.0 | Ø4.0 | 5 | 50 |
| M-01-149 | Ø1.0 | Ø4.0 | 5.5 | 50 |
| M-01-513 | Ø1.0 | Ø4.0 | 5.5 | 50 |
| M-01-258 | Ø1.0 | Ø4.0 | 6.5 | 50 |
| M-01-130 | Ø1.0 | Ø4.0 | 6.8 | 50 |
| M-01-177 | Ø1.0 | Ø4.0 | 7 | 50 |
| M-01-274 | Ø1.0 | Ø4.0 | 7 | 50 |
| M-01-530 | Ø1.0 | Ø4.0 | 7 | 50 |
| M-01-720 | Ø1.0 | Ø4.0 | 7.9 | 50 |
| M-01-731 | Ø1.0 | Ø4.0 | 11 | 50 |
| M-01-214 | Ø1.0 | Ø4.1 | 4 | 50 |
| M-01-249 | Ø1.0 | Ø4.3 | 5.4 | 50 |
| M-01-546 | Ø1.0 | Ø4.3 | 5.4 | 50 |
| M-01-081 | Ø1.0 | Ø4.5 | 3.5 | 50 |
| M-01-197 | Ø1.0 | Ø4.5 | 4.5 | 50 |
| M-01-978 | Ø1.0 | Ø4.5 | 4.7 | 51 |
| M-01-141 | Ø1.0 | Ø4.5 | 5 | 50 |
| M-01-551 | Ø1.0 | Ø4.5 | 5 | 50 |
| M-01-575 | Ø1.0 | Ø4.5 | 6.4 | 50 |
| M-01-137 | Ø1.0 | Ø4.5 | 7.5 | 50 |
| M-01-716 | Ø1.0 | Ø4.5 | 10 | 50 |
| M-01-095 | Ø1.0 | Ø4.6 | 8 | 50 |
| M-01-736 | Ø1.0 | Ø4.7±0.2 | 4.5±0.2 | 50 |
| M-01-254 | Ø1.0 | Ø4.7 | 6.5 | 50 |

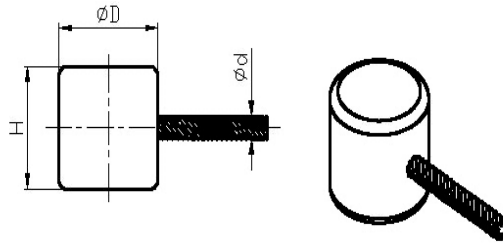

| ITEM NO. | Wire diameter (d) | DIMENSION | | MINI BREAK LOAD (kgf) |
|------------|-------------------|-----------|-----|-----------------------|
| | | D | H | |
| M-01-113 | Ø1.0 | Ø4.7 | 6.5 | 50 |
| M-01-473 | Ø1.0 | Ø4.7 | 6.5 | 50 |
| M-01-492 | Ø1.0 | Ø4.7 | 6.5 | 50 |
| M-01-969 | Ø1.0 | Ø4.7 | 6.5 | 50 |
| M-01-789 | Ø1.0 | Ø4.8 | 6 | 50 |
| M-01-841 | Ø1.0 | Ø4.9 | 7.9 | 50 |
| M-01-421 | Ø1.0 | Ø5.0 | 5 | 50 |
| M-01-182 | Ø1.0 | Ø5.0 | 6.5 | 50 |
| M-01-403 | Ø1.0 | Ø5.0 | 8 | 50 |
| M-01-581 | Ø1.0 | Ø5.0 | 7 | 51 |
| M-01-581-1 | Ø1.0 | Ø5.0 | 7 | 51 |
| M-01-411 | Ø1.0 | Ø5.2 | 5 | 50 |
| M-01-582 | Ø1.0 | Ø5.0 | 6 | 50 |
| M-01-583 | 1.0 | Ø5.0 | 7 | 50 |
| M-01-679 | 1.0 | Ø5.0 | 8 | 50 |
| M-01-666 | 1.0 | Ø5.0 | 8 | 50 |
| M-01-964 | 1.0 | 5.5 | 5.5 | 50 |
| M-01-157 | Ø1.0 | Ø6.0 | 4 | 50 |
| M-01-157-1 | Ø1.0 | Ø6.0 | 4 | 50 |
| M-01-159 | Ø1.0 | Ø6.0 | 6 | 50 |
| M-01-285 | Ø1.0 | Ø6.0 | 7 | 50 |
| M-01-303 | Ø1.0 | Ø6.0 | 8.5 | 50 |
| M-01-466 | Ø1.0 | Ø6.0 | 10 | 50 |
| M-01-244 | Ø1.0 | Ø7.0 | 7 | 50 |

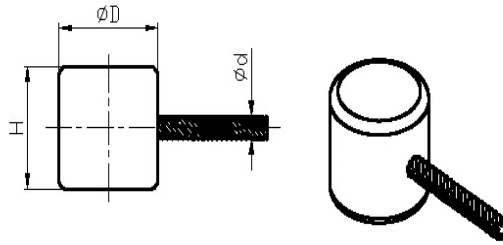

| ITEM NO. | Wire diameter (d) | DIMENSION | | MINI BREAK LOAD (kgf) |
|-----------|-------------------|-----------|------|-----------------------|
| | | D | H | |
| M-01-1025 | Ø0.8 coating Ø1.1 | 3.2 | 11.5 | 50 |
| M-01-979 | Ø0.8 coating Ø1.2 | 3.2 | 11.5 | 50 |
| M-01-259 | Ø1.2 | Ø3.5 | 5 | 100 |
| M-01-265 | Ø1.2 | Ø3.5 | 5 | 100 |
| M-01-072 | Ø1.2 | Ø3.8 | 5.5 | 100 |
| M-01-094 | Ø1.2 | Ø3.8 | 6 | 100 |
| M-01-420 | Ø1.2 | Ø3.8 | 10 | 100 |
| M-01-063 | Ø1.2 | Ø4.0 | 4 | 100 |
| M-01-757 | Ø1.2 | Ø4.0 | 4 | 100 |
| M-01-251 | Ø1.2 | Ø4.0 | 5 | 100 |
| M-01-296 | Ø1.2 | Ø4.0 | 5.3 | 100 |
| M-01-074 | Ø1.2 | Ø4.0 | 5.5 | 100 |
| M-01-482 | Ø1.2 | Ø4.0 | 6 | 100 |
| M-01-605 | Ø1.2 | Ø4.0 | 6 | 100 |
| M-01-054 | Ø1.2 coating | Ø4.0 | 7 | 100 |
| M-01-619 | Ø1.2 | Ø4.0 | 7 | 100 |
| M-01-620 | Ø1.2 | Ø4.0 | 7.8 | 100 |
| M-01-217 | Ø1.2 | Ø4.0 | 8 | 100 |
| M-01-632 | Ø1.2 coating | Ø4.0 | 9 | 30 |
| M-01-309 | Ø1.2 | Ø4.0 | 9.5 | 100 |
| M-01-362 | Ø1.2 | Ø4.0 | 10 | 100 |
| M-01-053 | Ø1.2 | Ø4.0 | 10 | 100 |
| M-01-771 | Ø1.0 coating Ø1.2 | Ø4.0 | 10 | 100 |
| M-01-375 | Ø1.2 | Ø4.0 | 12.5 | 100 |

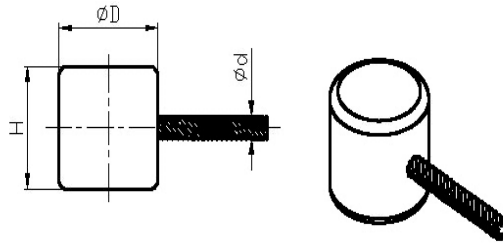

| ITEM NO. | Wire diameter (d) | DIMENSION | | MINI BREAK LOAD (kgf) |
|-----------|-------------------|-----------|-------|-----------------------|
| | | D | H | |
| M-01-761 | Ø1.2 | Ø4.4 | 8 | 100 |
| M-01-273 | Ø1.2 | Ø4.5 | 4.5 | 100 |
| M-01-337 | Ø1.2 | Ø4.5 | 5 | 100 |
| M-01-283 | Ø1.2 coating | Ø4.5 | 5.5 | 100 |
| M-01-115 | Ø1.2 | Ø4.5 | 10 | 100 |
| M-01-1010 | Ø1.2 | Ø4.88 | 5.1 | 100 |
| M-01-599 | Ø1.2 | Ø4.8 | 7.8 | 100 |
| M-01-606 | Ø1.2 | Ø4.8 | 7.8 | 100 |
| M-01-942 | Ø1.2 | Ø4.8 | 7.8 | 100 |
| M-01-732 | Ø1.2 | Ø4.8 | 5.08 | 100 |
| M-01-987 | Ø1.2 | Ø4.8 | 5.08 | 100 |
| M-01-748 | Ø1.2 | Ø4.95 | 10.16 | 100 |
| M-01-858 | Ø1.2 | Ø4.95 | 10.16 | 100 |
| M-01-414 | Ø1.2 | Ø5.0 | 4 | 100 |
| M-01-236 | Ø1.2 | Ø5.0 | 4.8 | 100 |
| M-01-059 | Ø1.2 | Ø5.0 | 6 | 100 |
| M-01-723 | Ø1.2 | Ø5.0 | 6 | 100 |
| M-01-905 | 1.2 | Ø5.0 | 6 | 100 |
| M-01-234 | Ø1.2 | Ø5.0 | 6.2 | 100 |
| M-01-592 | Ø1.2 | Ø5.0 | 6.5 | 100 |
| M-01-753 | Ø1.2 | Ø5.0 | 7.8 | 100 |
| M-01-061 | Ø1.2 | Ø5.0 | 8 | 100 |
| M-01-543 | Ø1.2 | Ø5.0 | 8 | 100 |
| M-01-595 | Ø1.2 | Ø5.0 | 8 | 100 |

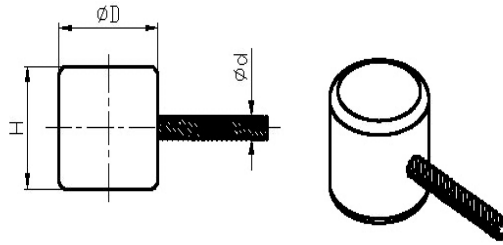

| ITEM NO. | Wire diameter (d) | DIMENSION | | MINI BREAK LOAD (kgf) |
|-----------|-------------------|-----------|------|-----------------------|
| | | D | H | |
| M-01-229 | Ø1.2 | Ø5.0 | 10 | 100 |
| M-01-584 | Ø1.2 | Ø5.0 | 7 | 100 |
| M-01-738 | Ø1.2 | Ø5.0 | 11 | 100 |
| M-01-818 | Ø1.2 | Ø5.0 | 11 | 100 |
| M-01-578 | Ø1.2 | Ø5.65 | 5.5 | 100 |
| M-01-719 | Ø1.2 | Ø5.8 | 11.7 | 100 |
| M-01-1029 | Ø1.2 | Ø5.8 | 15 | 100 |
| M-01-075 | Ø1.2 | Ø6.0 | 3 | 100 |
| M-01-103 | Ø1.2 | Ø6.0 | 4 | 100 |
| M-01-078 | Ø1.2 | Ø6.0 | 5 | 100 |
| M-01-012 | Ø1.2 | Ø6.0 | 6 | 100 |
| M-01-302 | Ø1.2 | Ø6.0 | 6 | 100 |
| M-01-665 | Ø1.2 | Ø6.0 | 7 | 100 |
| M-01-393 | Ø1.2 | Ø6.0 | 8 | 100 |
| M-01-478 | Ø1.2 | Ø6.0 | 10 | 100 |
| M-01-533 | Ø1.2 | Ø6.0 | 10 | 100 |
| M-01-230 | Ø1.2 | Ø7.0 | 6.2 | 100 |
| M-01-695 | Ø1.2 coating | Ø7.0 | 6.4 | 50 |
| M-01-781 | Ø1.2 | Ø6.0 | 8 | 100 |
| M-01-939 | Ø1.25 | Ø5.0 | 6 | 100 |
| M-01-231 | Ø1.25 | Ø5.0 | 7 | 100 |
| M-01-320 | Ø1.25 | Ø5.0 | 7 | 100 |
| M-01-552 | Ø1.25 | Ø6.0 | 6 | 100 |
| M-01-616 | Ø1.30 | Ø4.8 | 7.8 | 100 |

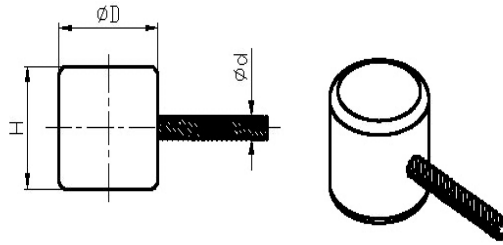

| ITEM NO. | Wire diameter (d) | DIMENSION | | MINI BREAK LOAD (kgf) |
|-----------|-------------------|-----------|------|-----------------------|
| | | D | H | |
| M-01-183 | Ø1.35 | Ø4.0 | 4.5 | 100 |
| M-01-059 | Ø1.30 | Ø5.0 | 6 | 100 |
| M-01-342 | Ø1.5 | Ø3.0 | 5 | 150 |
| M-01-777 | Ø1.5 | Ø3.0-Ø5 | 14.7 | 150 |
| M-01-597 | Ø1.5 | Ø3.9 | 6 | 150 |
| M-01-565 | Ø1.5 | Ø3.8 | 5 | 150 |
| M-01-306 | Ø1.5 | Ø3.8 | 10 | 150 |
| M-01-548 | Ø1.5 | Ø3.8 | 14 | 150 |
| M-01-854 | Ø1.5 | Ø4.0 | 4.7 | 150 |
| M-01-042 | Ø1.5 | Ø4.0 | 5.5 | 150 |
| M-01-431 | Ø1.5 | Ø4.0 | 5.5 | 150 |
| M-01-044 | Ø1.5 | Ø4.0 | 8 | 150 |
| M-01-550 | Ø1.5 | Ø4.0 | 8 | 150 |
| M-01-545 | Ø1.5 coating | Ø4.0 | 8 | 150 |
| M-01-618 | Ø1.5 | Ø4.0 | 8 | 150 |
| M-01-1008 | Ø1.5 | Ø4.0 | 12 | 150 |
| M-01-315 | Ø1.5 | Ø4.5 | 5 | 150 |
| M-01-766 | Ø1.5 | Ø4.5 | 8 | 150 |
| M-01-763 | Ø1.5 | Ø4.05 | 13.5 | 150 |
| M-01-192 | Ø1.5 | Ø4.5 | 11 | 150 |
| M-01-659 | Ø1.5 | Ø4.75 | 6 | 150 |
| M-01-408 | Ø1.5 | Ø4.75 | 10 | 150 |
| M-01-610 | Ø1.5 | Ø4.8 | 4.4 | 150 |
| M-01-600 | Ø1.5 | Ø4.8 | 7.8 | 150 |

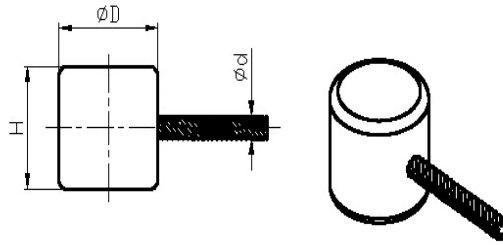

| ITEM NO. | Wire diameter (d) | DIMENSION | | MINI BREAK LOAD (kgf) |
|----------|-------------------|-------------------|-----|-----------------------|
| | | D | H | |
| M-01-607 | $\varnothing 1.5$ | $\varnothing 4.8$ | 7.8 | 150 |
| M-01-765 | $\varnothing 1.5$ | $\varnothing 4.8$ | 7.8 | 150 |
| M-01-943 | $\varnothing 1.5$ | $\varnothing 4.8$ | 7.8 | 150 |
| M-01-951 | $\varnothing 1.5$ | $\varnothing 4.8$ | 7.8 | 150 |
| M-01-985 | $\varnothing 1.5$ | $\varnothing 4.8$ | 7.8 | 150 |
| M-01-587 | $\varnothing 1.5$ | $\varnothing 4.9$ | 6.5 | 150 |
| M-01-801 | $\varnothing 1.5$ | $\varnothing 4.9$ | 6.5 | 150 |

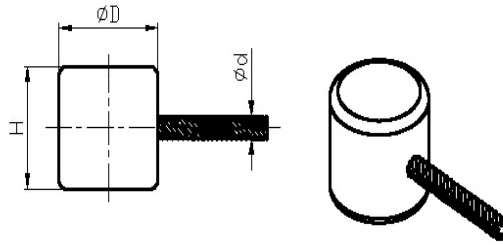

| ITEM NO. | Wire diameter (d) | DIMENSION | | MINI BREAK LOAD (kgf) |
|-------------|-------------------|-----------|---------|-----------------------|
| | | D | H | |
| M-01-642 | Ø1.5 | Ø4.8 | 6 | 150 |
| M-01-650 | Ø1.5 | Ø4.9 | 4.1 | 150 |
| M-01-810 | Ø1.5 | Ø4.9 | 4.1 | 150 |
| M-01-724 | Ø1.5 | Ø4.9 | 7 | 150 |
| M-01-324 | Ø1.5 | Ø5.0 | 6 | 150 |
| M-01-722 | Ø1.5 | Ø5.0 | 6 | 150 |
| M-01-936 | Ø1.5 | Ø5.0 | 6 | 150 |
| M-01-1018 | Ø1.5 | Ø5.0 | 6 | 150 |
| M-01-1018-1 | Ø1.5 | Ø5.0 | 6 | 150 |
| M-01-1019 | Ø1.5 | Ø5.0 | 7 | 150 |
| M-01-1019-1 | Ø1.5 | Ø5.0 | 7 | 150 |
| M-01-496 | Ø1.5 | Ø5.0 | 7 | 150 |
| M-01-747 | Ø1.5 | Ø5.0 | 7.5 | 150 |
| M-01-864 | Ø1.5 | Ø5.0 | 7.5 | 150 |
| M-01-549 | Ø1.5 | Ø5.0 | 7.7 | 150 |
| M-01-706 | Ø1.5 | Ø5.0 | 7.7 | 150 |
| M-01-518 | Ø1.5 | Ø5.0 | 8 | 150 |
| M-01-937 | Ø1.5 | Ø5.0 | 8 | 150 |
| M-01-598 | Ø1.5 | Ø5.0 | 8 | 150 |
| M-01-457 | Ø1.5 | Ø5.0 | 8.5 | 150 |
| M-01-022 | Ø1.5 | Ø5.0 | 10 | 150 |
| M-01-622 | Ø1.5 | Ø5.0 | 14 | 150 |
| M-01-955 | Ø1.5 | Ø5.0 | 6.7*6.9 | 150 |
| M-01-657 | Ø1.5 | Ø5.1 | 8 | 50 |

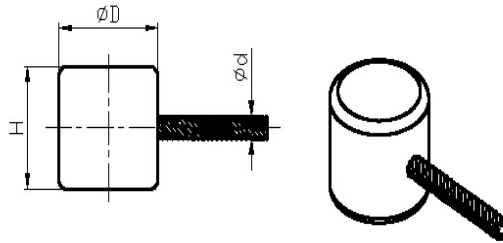

| ITEM NO. | Wire diameter (d) | DIMENSION | | MINI BREAK LOAD (kgf) |
|----------|-------------------|-----------|------|-----------------------|
| | | D | H | |
| M-01-006 | Ø1.5 | Ø5.1 | 6 | 150 |
| M-01-410 | Ø1.5 | Ø5.3 | 7.3 | 150 |
| M-01-525 | Ø1.5 | Ø5.5 | 6.35 | 150 |
| M-01-060 | Ø1.5 | Ø5.5 | 9.6 | 150 |
| M-01-039 | Ø1.5 | Ø5.8 | 4.8 | 150 |
| M-01-415 | Ø1.5 | Ø5.8 | 8 | 150 |
| M-01-853 | Ø1.5 | Ø5.9 | 3 | 150 |
| M-01-020 | Ø1.5 | Ø6.0 | 6 | 150 |
| M-01-361 | Ø1.5 | Ø6.0 | 6 | 150 |
| M-01-439 | Ø1.5 | Ø6.0 | 6 | 150 |
| M-01-019 | Ø1.5 | Ø6.0 | 7 | 150 |
| M-01-758 | Ø1.5 | Ø6.0 | 7 | 150 |
| M-01-405 | Ø1.5 | Ø6.0 | 10 | 150 |
| M-01-743 | Ø1.5 | Ø6.0 | 14.5 | 150 |
| M-01-926 | Ø1.5 | Ø6.0 | 15.1 | 150 |
| M-01-381 | Ø1.5 coating Ø2.0 | Ø6.2 | 7.8 | 150 |
| M-01-003 | Ø1.5 | Ø6.5 | 2.5 | 100 |
| M-01-045 | Ø1.5 | Ø6.7 | 6.3 | 150 |
| M-01-509 | Ø1.5 | Ø6.8 | 7 | 150 |
| M-01-585 | Ø1.5 | Ø6.8 | 12.5 | 150 |
| M-01-516 | Ø1.5 | Ø7.0 | 7 | 150 |
| M-01-128 | Ø1.5 | Ø7.0 | 7 | 150 |
| M-01-672 | Ø1.5 | Ø7.0 | 7 | 150 |
| M-01-886 | Ø1.5 | Ø7.0 | 9 | 150 |

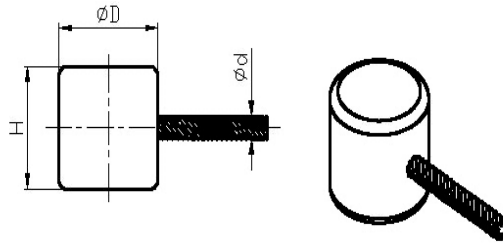

| ITEM NO. | Wire diameter (d) | DIMENSION | | MINI BREAK LOAD (kgf) |
|-----------|-------------------|-----------|------|-----------------------|
| | | D | H | |
| M-01-791 | Ø1.5 | Ø7.2 | 10.5 | 150 |
| M-01-245 | Ø1.5 | Ø7.8 | 15 | 150 |
| M-01-458 | Ø1.5 | Ø7.8 | 15 | 150 |
| M-01-855 | Ø1.5 | Ø8.0 | 4 | 150 |
| M-01-277 | Ø1.5 | Ø8.0 | 9 | 150 |
| M-01-664 | Ø1.6 | Ø6.2 | 5 | 100 |
| M-01-838 | Ø1.2 coating Ø1.6 | Ø2.5 | 4 | 100 |
| M-01-836 | Ø1.5 coating Ø2.0 | Ø4 | 5.5 | 200 |
| M-01-1001 | Ø1.5 coating Ø1.8 | Ø4 | 5.5 | 200 |
| M-01-099 | Ø1.8 | Ø4.8 | 9 | 200 |
| M-01-488 | Ø1.5 coating Ø1.8 | Ø 5.0 | 8 | 250 |
| M-01-029 | Ø1.8 | Ø 5.0 | 9 | 250 |
| M-01-239 | Ø1.8 | Ø 5.0 | 9 | 250 |
| M-01-774 | Ø1.5 coating Ø1.8 | Ø 5.0 | 9 | 250 |
| M-01-038 | Ø1.8 | Ø 5.0 | 10 | 250 |
| M-01-300 | Ø1.8 | Ø 5.0 | 10 | 250 |
| M-01-726 | Ø1.5 coating Ø1.8 | Ø 6.0 | 6 | 150 |
| M-01-852 | Ø1.8 | Ø 6.0 | 6 | 150 |
| M-01-474 | Ø1.8 coating | Ø 6.0 | 10 | 250 |
| M-01-1013 | Ø1.8 | Ø 6.0 | 14.4 | 250 |
| M-01-664 | Ø1.5 coating Ø1.8 | Ø 6.3 | 5 | 150 |
| M-01-071 | Ø1.8 | Ø 6.3 | 5.8 | 250 |
| M-01-235 | Ø1.8 | Ø7.0 | 6 | 150 |
| M-01-456 | Ø1.8 coating | Ø 7 | 6.4 | 200 |

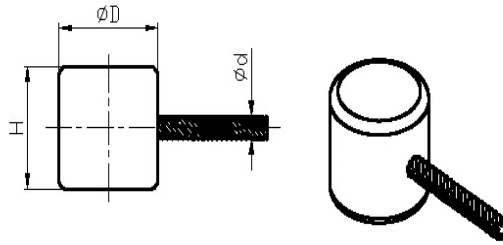

| ITEM NO. | Wire diameter (d) | DIMENSION | | MINI BREAK LOAD (kgf) |
|----------|-------------------|-----------|------|-----------------------|
| | | D | H | |
| M-01-846 | Ø1.5 coating Ø1.8 | Ø 7.0 | 7 | 200 |
| M-01-292 | Ø1.8 | Ø 7.0 | 7 | 200 |
| M-01-747 | Ø1.8 | Ø7.11 | 7.24 | 180 |
| M-01-334 | Ø1.8 | Ø 8.0 | 9 | 250 |
| M-01-246 | Ø1.8 | Ø 8.0 | 10 | 250 |
| M-01-800 | Ø1.5 coating Ø1.8 | Ø 8.0 | 10 | 250 |
| M-01-786 | Ø1.5 coating Ø1.8 | Ø 10 | 10 | 250 |
| M-01-793 | Ø1.5 coating Ø1.8 | Ø6 | 18.0 | 180 |
| M-01-017 | Ø2.0 | Ø 6.0 | 10 | 300 |
| M-01-713 | Ø2.0 | Ø 6.0 | 10 | 300 |
| M-01-988 | Ø2.0 | Ø 6.0 | 12 | |
| M-01-138 | Ø2.0 | Ø 7.0 | 7 | 300 |
| M-01-368 | Ø2.0 | Ø8.0 | 9 | 400 |
| M-01-326 | Ø2.0 | Ø8.0 | 10 | 400 |
| M-01-989 | Ø2.0 | Ø8.0 | 12 | 400 |
| M-01-623 | Ø2.0 coating Ø2.5 | Ø6.0 | 11 | 300 |
| M-01-015 | Ø2.5 | Ø 6.0 | 10 | 400 |
| M-01-430 | Ø2.5 | Ø 6.0 | 10 | 400 |
| M-01-837 | Ø2.5 | Ø 7.2 | 10.5 | 400 |
| M-01-480 | Ø2.5 | Ø 7.8 | 10 | 400 |
| M-01-367 | Ø2.5 | Ø 8.0 | 9 | 400 |
| M-01-058 | Ø2.5 | Ø 8.0 | 10 | 400 |
| M-01-694 | Ø2.5 | Ø 8.0 | 12 | 500 |
| M-01-508 | Ø2.5 | Ø 12.0 | 14 | 500 |

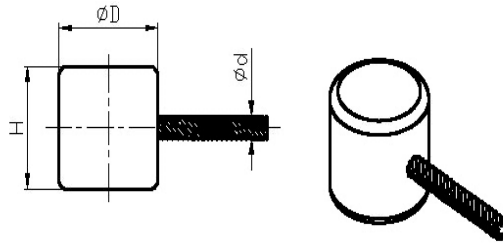

| ITEM NO. | Wire diameter (d) | DIMENSION | | MINI BREAK LOAD (kgf) |
|----------|-------------------|-----------|-----|-----------------------|
| | | D | H | |
| M-01-925 | Ø2.5 | Ø 12.0 | 14 | 500 |
| M-01-755 | Ø3.0 | Ø 12.0 | 14 | 800 |
| M-01-715 | Ø3.0 coating Ø4.0 | Ø7 | 8 | 500 |
| M-01-495 | Ø3.2 | Ø 12.0 | 14 | 500 |
| M-01-514 | Ø3.5 | Ø 12.0 | 14 | 500 |
| M-01-925 | Ø3.5 | Ø 12.0 | 14 | 500 |
| M-01-453 | Ø3.6 | Ø 10.0 | 14 | 400 |
| M-01-289 | Ø4.0 | Ø7.9 | 8.1 | 1000 |
| M-01-343 | Ø4.0 | Ø7.9 | 8.1 | 1000 |
| M-01-735 | Ø4.0 | Ø12 | 14 | 1000 |
| M-01-544 | Ø4.2 | Ø 10 | 10 | 1000 |