

ITEM NO.	Wire diameter (d)	DIMENSION					MINI BREAK LOAD (kgf)
		ØD	D1	L	T	W	
M-01-261	Ø0.8	Ø2.2	Ø6.0	9.2	2.2	3.6	50
M-01-733	Ø0.8	Ø5.0	Ø10	13.5	3.0	5.0	50
M-01-963	Ø0.8	Ø5.0	Ø10	13.5	3.0	5.0	50
M-01-216	Ø0.8	Ø5.0	Ø11.0	16.0	3.0	5.2	50
M-01-767	Ø0.8	Ø3.1	Ø8	8.6	2.5	3.0	50
M-01-775	Ø0.8	Ø3.1, Ø4	Ø8, Ø9	8.6, 10	2.5	3.0	50
M-01-776	Ø0.8	Ø3.1	Ø8	8.6	2.5	3.0	50
M-01-899-2	Ø0.8	Ø3.2	Ø7		2.5		
M-01-1017	Ø0.8	Ø3.4	Ø10.5	15.5	3.0		
M-01-828	Ø0.8	Ø4.0	9.5	10.3	2.5	4.0	
M-01-701	Ø0.8	Ø3.0	Ø9.4	11.0	/	3.9	50
M-01-834	Ø0.8	Ø5.0	Ø10	15.6	3.0	5.0	50
M-01-867	Ø0.8	Ø5.0	Ø10	15.6	3.0	5.0	50
M-01-932	Ø0.8	Ø5.0	Ø10	10.7	3.0	5.0	50
M-01-932-1	Ø0.8	Ø5.0	Ø10	10.7	3.0	5.0	50
M-01-932-2	Ø0.8	Ø5.0	Ø10	10.7	3.0	5.0	50
M-01-932-3	Ø0.8	Ø5.0	Ø10	10.7	3.0	5.0	50
M-01-173	Ø1.0	Ø2.0	Ø6.5	12.2	3.0	/	50
M-01-238	Ø1.0	Ø2.2	Ø6.0	9.2	2.2		50
M-01-253	Ø1.0	Ø3.2	Ø7.0	11.5	3.0	6.0	50
M-01-168	Ø1.0	Ø3.2	Ø7.7	17.8	3.8	3.9	50
M-01-290	Ø1.0	Ø3.3	Ø7.8	10.9	3.0	3.0	50
M-01-171	Ø1.0	Ø3.3	Ø7.3	10.5	3.0	2.9	100

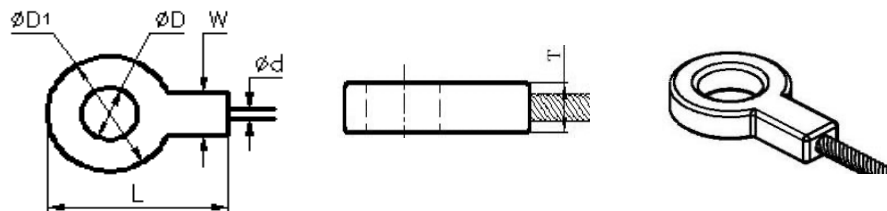

ITEM NO.	Wire diameter (d)	DIMENSION					MINI BREAK LOAD (kgf)
		ØD	D1	L	T	W	
M-01-226	Ø1.0	Ø3.3	Ø8.2	8.2	2.0	/	50
M-01-426	Ø1.0	Ø3.4	Ø7.5	10.8	2.8	2.8	50
M-01-817	Ø1.0	Ø4.2			2.5		
M-01-120	Ø1.0	Ø4.2	Ø8.0	15.0	3.2	2.7	50
M-01-276	Ø1.0	Ø4.2	Ø8.0	15.0	3.2	2.7	50
M-01-811	Ø1.0	Ø4.2	Ø8.0	15.0	2.9	3.1	50
M-01-119	Ø1.0	Ø4.2	Ø8.0	18.0	3.1	3.1	50
M-01-816	Ø1.0	Ø4.2	Ø8.0	18.0	3.1	3.1	50
M-01-070	Ø1.0	Ø4.5	Ø11.0	26.0	2.5	4.0	100
M-01-684	Ø1.0	Ø4.5	Ø6	9.0	2.1	5.0	100
M-01-899	Ø1.0	Ø5.0	Ø10.0		2.0		
M-01-243	Ø1.0	Ø5.2	Ø7.8	14.5	3.0	5.0	80
M-01-351	Ø1.0	Ø5.2	Ø10.0	14.5	2.9	5.0	80
M-01-294	Ø1.0	Ø5.2	Ø12.0	12.0	3.0	/	50
M-01-752	Ø1.0	Ø5.3	Ø10.9	20.9	2.0	5.0	
M-01-350	Ø1.0	Ø7.0	Ø11.5	33.9	3.0	5.0	100

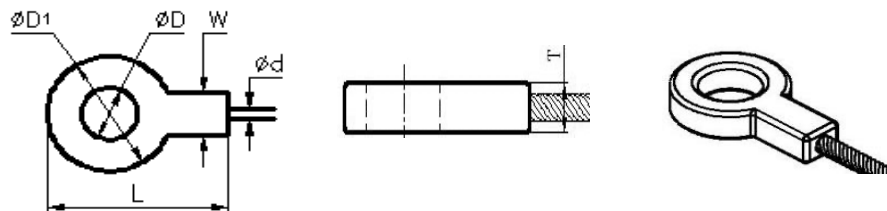

ITEM NO.	Wire diameter (d)	DIMENSION					MINI BREAK LOAD (kgf)
		ØD	D1	L	T	W	
M-01-255	Ø1.0	Ø8.0	Ø14.0	19.0	6.0	3.1	80
M-01-333	Ø1.0	Ø9.0	Ø13.0	28.5	3.0	5.0	80
M-01-319	Ø1.0	Ø9.0	Ø14.0	19.0	3.0	6.0	80
M-01-349	Ø1.0	Ø9.0	Ø14.8	29.4	3.0	5.0	80
M-01-193	Ø1.2	Ø3.0	Ø12.5	26.0	3.0	4.3	80
M-01-122	Ø1.2	Ø3.2	Ø8.5	8.5	2.0	/	80
M-01-451	Ø1.2	Ø3.5	Ø8.0	11.0	/	/	80
M-01-264	Ø1.2	Ø3.5	Ø10.0	10.0	2.5	/	100
M-01-352	Ø1.2	Ø4.2	Ø9.0	12.5	3.0	3.0	100
M-01-318	Ø1.2	Ø4.2	Ø9.0	12.5	3.0	3.0	100
M-01-066	Ø1.2	Ø4.9	Ø10.0	16.0	4.1	2.7	100
M-01-305	Ø1.2	Ø5.0	Ø11.0	15.0	3.0	5.0	100
M-01-213	Ø1.2	Ø5.0	Ø11.0	16.0	3.0	5.2	50
M-01-323	Ø1.2	Ø5.0	Ø11.0	16.0	3.0	5.0	100
M-01-089	Ø1.2	Ø5.0	Ø11.0	16.0	3.0	5.0	100
M-01-661	Ø1.2	Ø2.1	Ø5.0	12.5	3.2	3.5	100
M-01-652	Ø1.2	5*8	11.0	18.0	3.0	5.0	100
M-01-184	Ø1.2	Ø5.2	Ø9.0	16.0	3.0	5.1	100
M-01-202	Ø1.2	Ø5.2	Ø10.0	15.0	3.1	5.0	100
M-01-256	Ø1.2	Ø5.5	Ø8.5	16.5	2.0	4.5	100
M-01-240	Ø1.2	Ø5.5	Ø12.0	12.0	2.0	/	80
M-01-636	Ø1.2	Ø5.8	Ø11.5	16.2	3.1	5.0	100
M-01-139	Ø1.2	Ø6.5	Ø10	15.0	2.8	4.0	80

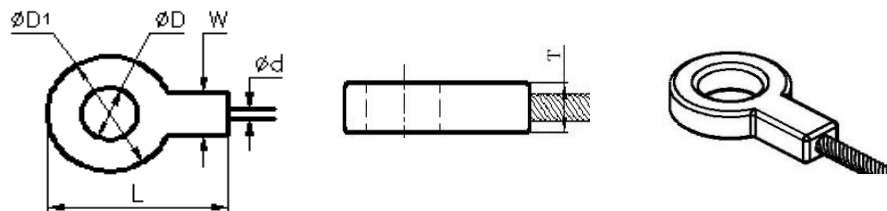

ITEM NO.	Wire diameter (d)	DIMENSION					MINI BREAK LOAD (kgf)
		ØD	D1	L	T	W	
M-01-064	Ø1.2	Ø6.5	Ø10.2	15.0	2.7	4.4	100
M-01-194	Ø1.2	Ø6.5	Ø12.5	19.2	3.0	4.1	100
M-01-110	Ø1.2	Ø8.7	Ø15.0	23.8	2.6	5.2	100
M-01-617	Ø1.2	Ø6.2	Ø10	15.0	5.0	4.0	100
M-01-654	Ø1.5	Ø3.1	Ø8.6	14.0	3.25	5.0	150
M-01-174	Ø1.5	Ø3.7	Ø8.3	12.0	4.0	5.0	150
M-01-1030	Ø1.5	Ø3.7	Ø8.5	12.5	4.0	8.5	
M-01-1030-2	Ø1.5	Ø3.8	Ø8.5	12.5	4.0	8.5	
M-01-912	Ø1.5	4.2		13.0	3.0		150
M-01-832	Ø1.6	Ø4.8	18.9		3.1	6.3	150
M-01-674	Ø1.5	Ø4.9	Ø9.7	20.9	/	/	220
M-01-769	Ø1.5	Ø5.0	Ø11.0	15.0		/	
M-01-167	Ø1.5	Ø5.0	Ø11.0	15.0	2.9	5.0	150
M-01-739	Ø1.5	Ø5.0+0.3	12.0	15.5	4.0	6.0	150
M-01-739-1	Ø1.5	Ø5.0+0.3	12.0	15.5	4.0	6.0	150
M-01-739-2	Ø1.5	Ø5.0+0.3	12.0	15.5	4.0	6.0	150
M-01-627	Ø1.5 coating	Ø5.1	Ø11.0	15.0	2.9	5.0	150
M-01-691	Ø1.5	Ø5.1	Ø11.0	15.0	2.9	5.0	150
M-01-711	Ø1.5	Ø5.1	Ø11.0	15.0	2.9	5.0	150
M-01-588	Ø1.5	Ø5.0	Ø11.0	25.5	2.4	4.3	150
M-01-356	Ø1.5	Ø5.0	Ø11.0	25.5	2.4	4.3	150
M-01-658	Ø1.5	Ø5.2	Ø16.6	22.6	5.0	8.7	150
M-01-142	Ø1.5	Ø5.2	Ø9.5	19.5	/	4.5	150

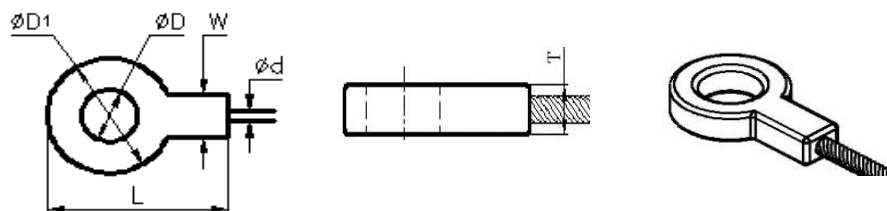

ITEM NO.	Wire diameter (d)	DIMENSION					MINI BREAK LOAD (kgf)
		ØD	D1	L	T	W	
M-01-675	Ø1.5	Ø5.2	Ø15.0	20.0	4.2		150
M-01-750	Ø1.5	Ø5.25	Ø15	20.0	4.0		150
M-01-869	Ø1.5	Ø5.2	Ø15	20.0	4.0		150
M-01-875	Ø1.5	Ø5.2	Ø15	20.0	4.05		150
M-01-778	Ø1.5	Ø5.25	10.2	20.0	4.0		150
M-01-772	Ø1.5	Ø5.2	Ø10.7	19.1	3.8		150
M-01-913	Ø1.5	Ø5.2	Ø10.7	19.1	3.8		150
M-01-1000	Ø1.5	Ø5.2	Ø10.7	19.1	3.8		150
M-01-667	Ø1.5	Ø6.0	Ø13.0	17.0	3.0	5.0	150
M-01-088	Ø1.5 coating	Ø6.5	Ø14.0	20.0	4.0	4.3	150
M-01-434	Ø1.5	Ø6.8	Ø13.3	21.4	4.5		150
M-01-147	Ø1.5	Ø6.8	Ø14.0	22.8	3.8	3.5	150
M-01-433	Ø1.5	Ø8.2	Ø17.6	27.8	6.0	/	150
M-01-465	Ø1.5	Ø8.6	Ø16.4	28.4	/	/	200
M-01-082	Ø1.5	Ø8.7	Ø14.5	23.8	2.5	/	150
M-01-638	Ø1.5	Ø10.3	Ø18	24.0	5.0	/	150
M-01-673	Ø1.5	Ø5*10	15*20	20.0	4.0	/	150
M-01-728	Ø1.5	Ø5.2	15.2	19.2	4.3		150
M-01-802	Ø1.5	Ø5.2	Ø13	21.5	4.4		150
M-01-975	Ø1.5	10.3	24.0				
M-01-579	Ø1.6	Ø7.1	Ø11.1	17.6	4.2	Ø4.0	200
M-01-591	Ø1.68	Ø7.0	Ø13.76	22.0	4.4	Ø4.3	150
M-01-611	Ø1.65 coating	Ø7.0	Ø13.70	21.8	4.4	Ø4.4	150

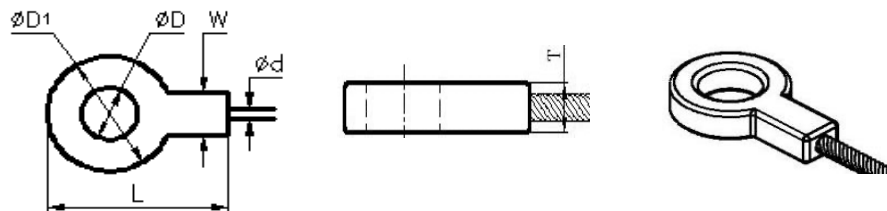

ITEM NO.	Wire diameter (d)	DIMENSION					MINI BREAK LOAD (kgf)
		ØD	D1	L	T	W	
M-01-558	Ø1.7	Ø6.8	Ø13.2	21.6		Ø4.4	200
M-01-835	Ø1.8	Ø5.0	Ø12	15.5	4.0	6.0	150
M-01-712	Ø2.0	Ø4.9	Ø10.6	17.3	3.0	6.5	200
M-01-449	Ø2.0	Ø5.0	Ø8.9	16.7		5.3	200
M-01-520	Ø2.0	Ø5.2	Ø11.0	15.3	4.6	/	200
M-01-740	Ø2.0	Ø5.2	Ø11.0	15.3	4.6	/	200
M-01-118	Ø2.0	Ø6.0	Ø11.8	17.8	4.8	4.8	200
M-01-751	Ø2.0	Ø6.0	Ø12	25.0	5.0	5.0	200
M-01-357	Ø2	Ø6.5	Ø14.6	18.5	4.3	4.8	200
M-01-683	Ø2.4	Ø6.2	Ø9.5	16.2	4.5	6.0	
M-01-148	Ø2.5 coating	Ø5.0	Ø10.5	23.0	4.0	4.0	100
M-01-489	Ø2.5 coating	Ø5.0	Ø12.0	23.5	4.0		200
M-01-221	Ø2.5 coating	Ø5.0	Ø12.0	23.5	4.5	4.2	180
M-01-129	Ø2.5	Ø6.2	Ø15.0	23.5	4.4	4.8	400
M-01-123	Ø2.5 coating	Ø6.5	Ø15.0	18.5	4.6	4.8	400
M-01-444	Ø2.5 coating	Ø6.8	Ø13.2	21.6	4.4	4.4	200
M-01-445	Ø2.5 coating	Ø8.4	Ø16.2	27.4	5.8	5.8	200
M-01-559	Ø2.5	Ø8.4	Ø16.2	27.4	5.8	5.8	200
M-01-521	Ø3.2	Ø8.3	Ø17.8	25.0	7.4	/	400